

Replacing your rain sensor.

This is a very simple process and since I had to do it, I thought I would take pictures and post the info.

Symptoms: My windshield wipers, when different intermittent times were selected, would only go back and forth at one speed. They also did not react to varying rain strengths. So that means that no matter how fast or slow the rain comes down as well as stopping at a stop light, the wipers only went one speed when set at the various intermittent settings.

Cure: Replace the actual rain sensor.

First speed bump: When the dealer researches the rain sensor, you should give them the part number for the actual sensor because if they do the standard search, their database shows that you have to purchase the rain sensor with a brand new windshield. This is just the way the first search goes for most dealers. The pictures below show the actual rain sensor and the part number I used was: #61356904012

The RealOEM picture and the part (#1) and link is:

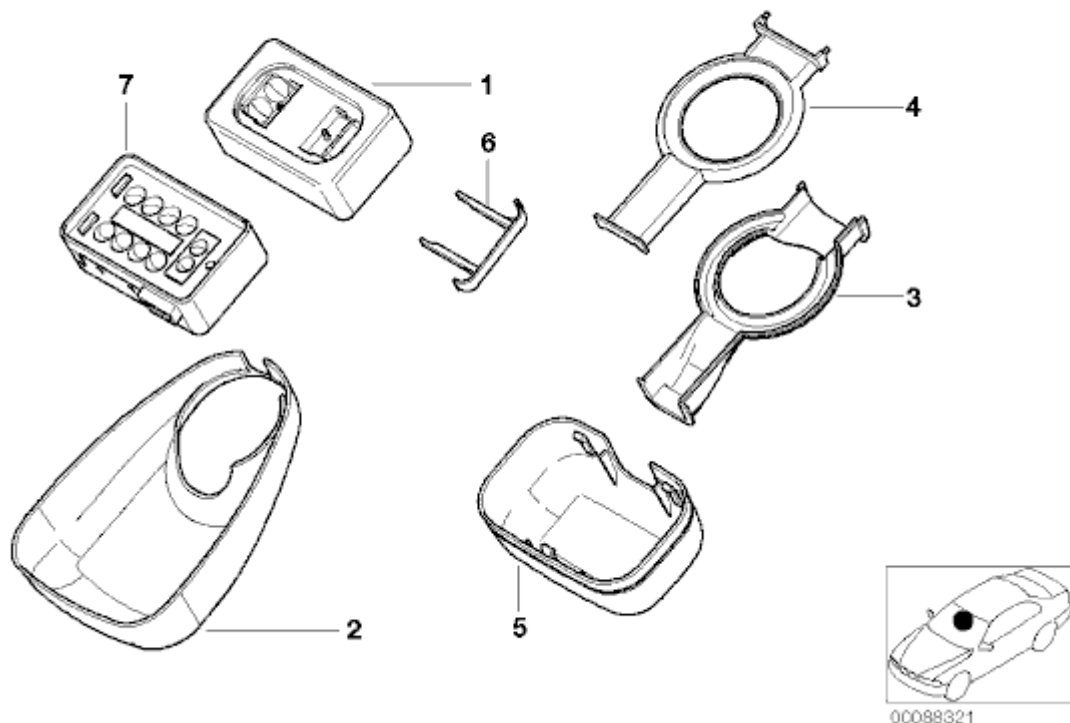

http://www.realoem.com/bmw/showparts.do?model=GH83&mospid=47531&btr=61_0169&hg=61&fg=15

Removal and install:

If you have the rain sensor, it should be located behind the rearview mirror. Picture1 shows the covers that sit behind the rearview mirror that are covering the rain sensor. These covers pop apart from the sensor and Picture2 shows the part of the cover that holds them together.

Once removed, there are 2 pieces of the rain sensor and the black plastic piece removes from the part of the sensor that is glued to the windshield. Picture3 shows the removable part that you will replace. Unplug the wire from the sensor (just pulls out) and then (as shown in Picture 4), pull the 'arms' (#1 circled in the picture), from the right and left edge, out and away from the sensor and it can be pulled from the windshield. This leaves the part of the rain sensor, Picture5, that will stay glued to the windshield. There is no need to remove this.

So at this point, the rain sensor should be off the windshield, and you should get out the new sensor. For mine, the old sensor had a 'SW:1.3' noted in the bottom corner and new one said 'SW:1.4' which is pictured in Picture6. I assume this means software, but just a note that the one you get from the dealer may say 1.4 as mine did. Then again, when you read this in the future, maybe they will be up to 1.5. :-)

The new rain sensor goes on the exact way the old one came off. It may take a bit of pushing to make sure it is flush so that the arms lock the sensor in place. Give it a nice little tug to make sure it is secure. Also make sure it is flush against the windshield on all 4 edges. Since there are 4 'arms' in the sensor, they all need to be secured for proper long term fit.

Although blurry (my apologies), it should look like Picture7 in the beginning before you start and in the end after you have reseated the new sensor.

Last but not least, make sure you put the covers back on and make sure the wiring at the top of the cover does not get pinched when reseating the covers.

If all went well and it was really the sensor causing your issues, you should now have correctly working rain sensing wipers. Good luck!

Picture1: Covers behind the rearview mirror that sit over the rain sensor.



Picture2: Tabs on the cover that keep the 2 pieces together



Picture3: Picture of the actual rain sensor that is being replaced



Picture4: Another picture of rain sensor with the arms that move out from each side (#1) and the areas (#2 and #3) where the arms secure the sensor

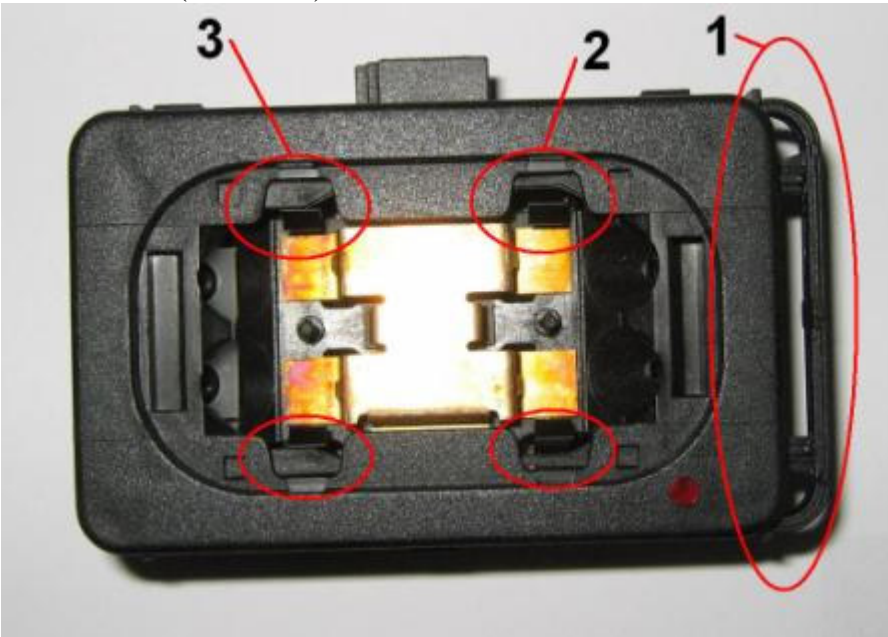

Picture5: View of the part of the rain sensor that is glued to the windshield and did not (in my case) need to be replaced

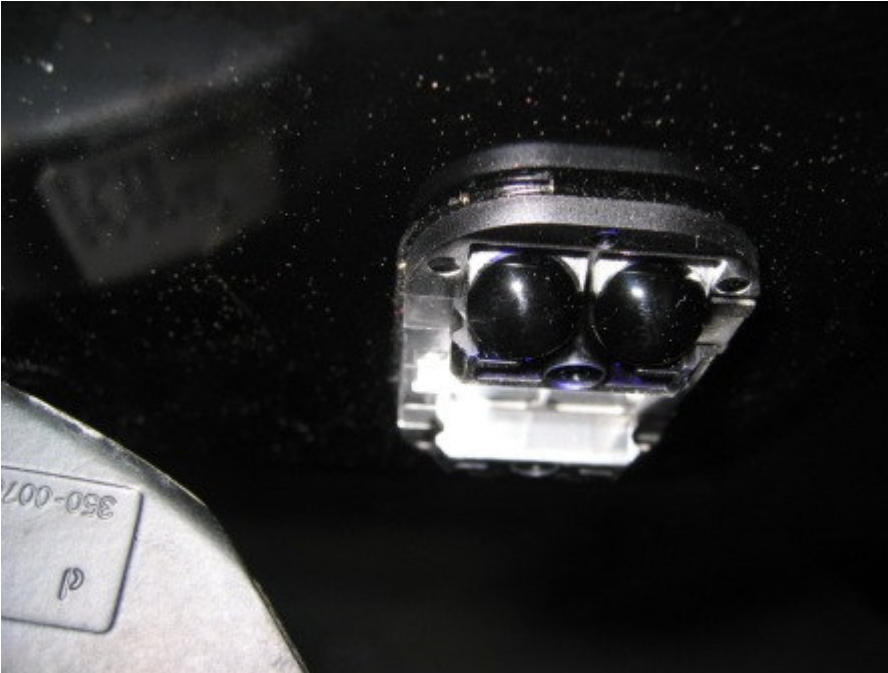

Picture6: The back view of the new rain sensor



Picture7: Same view of either before and after of the sensor placed on the windshield.
Blurry.. my apologies.

